

# HEAVY DUTY GLASS DOOR BOTTLE COOLERS

Item: 50058

Model: BB-CN-0012-GH

Item: 50060

Model: BB-CN-0016-GH

Item: 31863

Model: BB-CN-0020-G

*KEEP BEVERAGES CHILLED AND READY TO  
SERVE*

Perfect for any restaurant and/or bar, the heavy duty glass door bottle coolers are designed with enduring quality and value. The exterior comprises of attractive corrosion resistant vinyl on steel in black finish. Electronic control system makes it easy to adjust temperature set point and defrost frequency.





Authorized Dealer

SERVING THE FOOD INDUSTRY SINCE 1951



# REFRIGERATION

49-INCH HEAVY DUTY GLASS DOOR BOTTLE COOLER



## Features:

- Durable stainless steel top, interior walls, floor and ceiling
- Exterior construction is attractive corrosion resistant vinyl on steel in black finish
- Self-closing doors with locks
- LED interior lighting
- Adjustable heavy-duty PVC coated shelves
- Electronic control system makes it easy to adjust temperature set point and defrost frequency
- Temperature range from 0-5°C / 33-41°F



## TECHNICAL SPECIFICATION

ITEM NUMBER	50058
MODEL	BB-CN-0012-GH
POWER	1/5 HP
PRODUCT CAPACITY	672 - 12 oz. cans
	2 - kegs
PRODUCT CAPACITY	384 - 12 oz. bottles
	2
NUMBER OF DOORS	2
TEMPERATURE RANGE	33°F - 41°F / 0.5°C - 5°C
CAPACITY	11.8 cu. ft. / 335 L
NUMBER OF SHELVES	4
ELECTRICAL	115V / 60Hz / 1Ph
AMPS	2.88
REFRIGERANT	R290
DIMENSIONS (DWH)	48.8" x 24.4" x 35.6" 1240 x 620 x 905 mm
INTERIOR DIMENSIONS (DWH)	36 1/4" x 18 1/2" x 30 1/2" 920 x 470 x 775 mm
PACKAGING DIMENSIONS	51 1/8" x 27 4/8" x 42 3/8" 1300 x 700 x 1075 mm
WEIGHT	98 kg. / 216 lbs.
PACKAGING WEIGHT	118 kg. / 260 lbs.

## TECHNICAL DRAWING AND DIMENSIONS

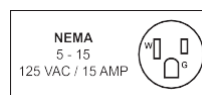
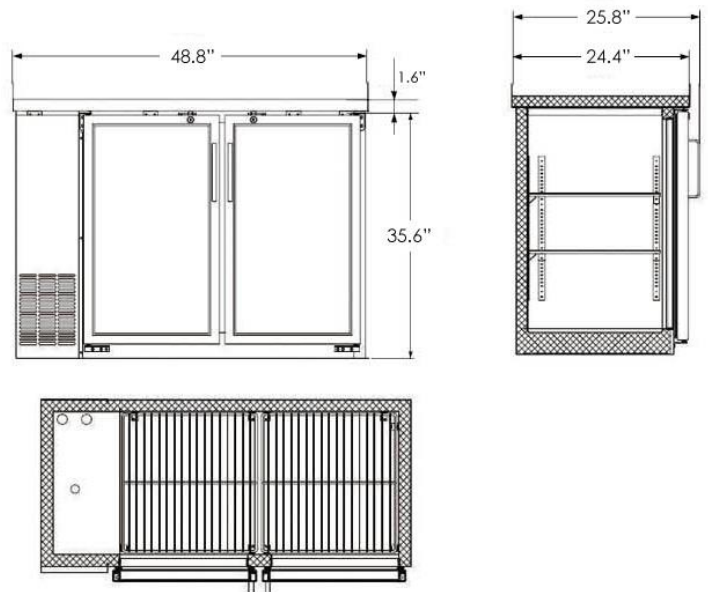

**WARRANTY**  
1 YEAR PARTS AND LABOR  
5 YEARS PARTS ON COMPRESSOR

## OMCAN INC.

Telephone: 1-800-465-0234  
Fax: (905) 607-0234  
Email: sales@omcan.com  
Website: www.omcan.com



Follow us to keep up to date with the latest news and offers



2017.E.O.E

# REFRIGERATION

61-INCH HEAVY DUTY GLASS DOOR BOTTLE COOLER



## Features:

- Durable stainless steel top, interior walls, floor and ceiling
- Exterior construction is attractive corrosion resistant vinyl on steel in black finish
- Self-closing doors with locks
- LED interior lighting
- Adjustable heavy-duty PVC coated shelves
- Electronic control system makes it easy to adjust temperature set point and defrost frequency
- Temperature range from 0-5°C / 33-41°F



## TECHNICAL SPECIFICATION

ITEM NUMBER	50060
MODEL	BB-CN-0016-GH
POWER	1/5 HP
PRODUCT CAPACITY	912 - 12 oz. cans
	2 - kegs
PRODUCT CAPACITY	504 - 12 oz. bottles
NUMBER OF DOORS	2
TEMPERATURE RANGE	33°F - 41°F / 0.5°C - 5°C
CAPACITY	15.8 cu. ft. / 446 L
NUMBER OF SHELVES	4
ELECTRICAL	115V / 60Hz / 1Ph
AMPS	2.88
REFRIGERANT	R290
DIMENSIONS (WDH)	60.8" x 24.4" x 35.6"
	1544 x 620 x 905 mm
INTERIOR DIMENSIONS (DWH)	20" x 48.2" x 31"
	507 x 1224 x 787 mm
PACKAGING DIMENSIONS	27.6" x 63.4" x 42.3"
	701 x 1610 x 1074 mm
WEIGHT	326 lbs. / 148 kg.
PACKAGING WEIGHT	380 lbs. / 173 kg.

## TECHNICAL DRAWING AND DIMENSIONS

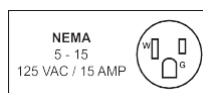
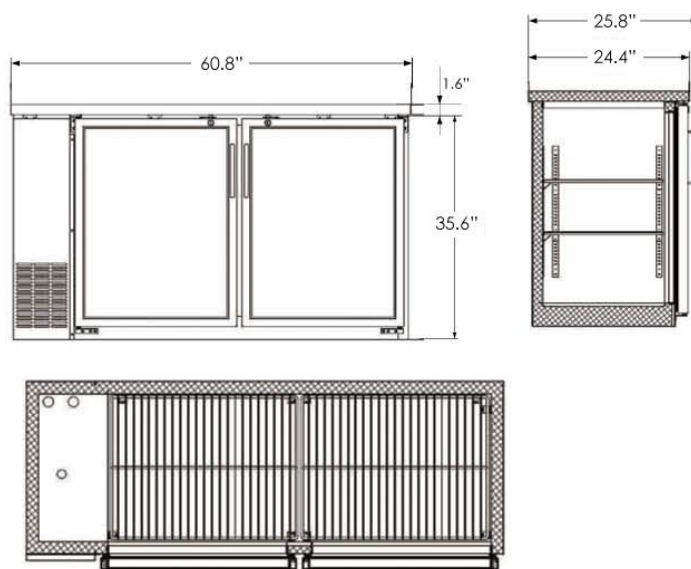

## WARRANTY

1 YEAR PARTS AND LABOR  
5 YEARS PARTS ON COMPRESSOR

## OMCAN INC.

Telephone: 1-800-465-0234

Fax: (905) 607-0234

Email: sales@omcan.com

Website: www.omcan.com



Follow us to keep up to date with the latest news and offers



2017.E.O.E



# REFRIGERATION

73-INCH HEAVY DUTY GLASS DOOR BOTTLE COOLER



## Features:

- Interior--stainless steel 304 floor and side
- Exterior--heavy duty, wear black resistant coating paint
- NSF-7 approved for packaged and bottle product
- Positive seal doors with lock and key
- LED light
- Product capacity: 1152 - 12 oz. cans / 3 kegs / 624 - 12 oz. bottles
- Temperature range from 0-5°C / 33-41°F



## TECHNICAL SPECIFICATION

ITEM NUMBER	31863
MODEL	BB-CN-0020-G
POWER	0.504 kW
PRODUCT CAPACITY	1152 - 12 oz. cans
	624 - 12 oz. bottles
NUMBER OF DOORS	3
TEMPERATURE RANGE	33 ~ 41°F / 0 ~ 5°C
CAPACITY	19.6 cu. ft. / 556 L
NUMBER OF SHELVES	6
COMPRESSOR HP	1/3+
ELECTRICAL	115V / 60Hz / 1Ph
AMPS	7.4A
DIMENSIONS (DWH)	24.4" x 72.8" x 36.2" 620 x 1849 x 919 mm
INTERIOR DIMENSIONS (DWH)	20" x 60.2" x 31" 507 x 1528 x 787 mm
PACKAGING DIMENSIONS	27.6" x 75.2" x 42.3" 701 x 1910 x 1074 mm
WEIGHT	355 lbs. / 161 kg.
PACKAGING WEIGHT	410 lbs. / 186 kg.

## TECHNICAL DRAWING AND DIMENSIONS

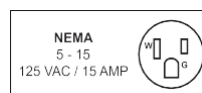
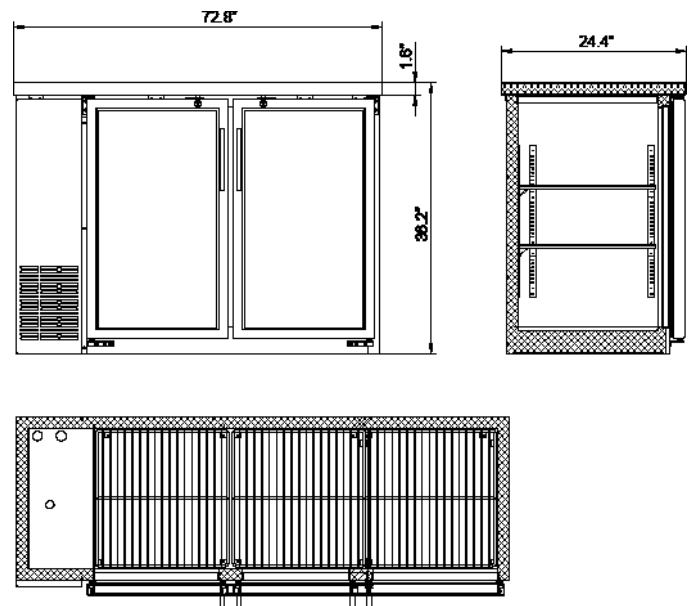

**WARRANTY**  
1 YEAR PARTS AND LABOR  
5 YEARS PARTS ON COMPRESSOR

## OMCAN INC.

Telephone: 1-800-465-0234

Fax: (905) 607-0234

Email: sales@omcan.com

Website: www.omcan.com



Follow us to keep up to date with the latest news and offers



2015.E.O.E