

**VALPRO COMMERCIAL REFRIGERATION**

5256 Eagle Trail Drive

Tampa, FL 33634

813-502-0300

Toll Free 1-888-VALPRO-8

www.ValproRefrigeration.comsales@ValproRefrigeration.com

PROJECT:

MODEL #:

ITEM #:

QTY:

AVAILABLE W/H:

APPROVAL:

GLASS DOOR BACK BAR COOLER 61" MODEL: VP60G

We are proud to introduce the beautifully constructed **Valpro VP60G double glass door 61" back bar refrigerator**. All our bar refrigeration equipment are manufactured with uncompromising quality, energy efficient technology, and standard premium features built in. All our back bar refrigerators have full stainless steel interiors, stainless steel framework construction, LED lighting, and heavy duty 1.6" solid foamed 304 stainless steel tops. This model will provide many years of worry free service and delivers cost saving eco-friendly energy efficiency. All our units exceed the new 2017 DOE energy standards and deliver superior energy efficiency with more affordable running costs. This unit utilizes an over-sized balanced refrigeration system allowing fast beverage cooling and shorter run times in a busy commercial environment. All our bar refrigeration equipment utilize natural hydrocarbon R290 or R600A refrigerant as an environmentally responsible choice having low global warming potential and no potential for ozone depletion. All Valpro products are manufactured under strict ISO9001 standards for quality assurance, and to consistently deliver to our customers products that satisfy all expectations. All our products are operated, extensively monitored, and undergo rigorous inspection prior to packaging and shipping.

KEY FEATURES

- Heavy duty 24" deep by 1.6" thick solid foamed 304 stainless steel top
- Full stainless steel interior, stainless steel framework
- LED lighting interior
- Attractive black powder coated galvanized steel exterior
- Self closing doors
- 2 energy saving vacuum-insulated triple pane low E-glass doors
- Efficient ECM fan motors
- Snap-in magnetic door gaskets removable and replaceable without tools for ease of cleaning
- Standard door locks for added security
- 4 heavy duty, wire shelves supported by pilasters for easy adjustability, 1/2" increments
- Four 4" casters (standard), front locking, make it easy to maneuver and clean underneath
- High density 2.4" foamed in-place CFC free polyurethane insulation
- Over sized balanced refrigeration system uses environmentally friendly R290 hydrocarbon refrigerant with low GWP and zero ozone depletion
- Extra large evaporator coil balanced with higher horsepower compressor and large condenser provide better reliability and performance
- Side mounted front breathing and front accessible condensing unit for easy cleaning
- Front mounted electronic thermostat digitally controlled temperature system maintains optimum temperature with easily viewed LED display
- ETL certified and tested to NSF Standard 7

**WARRANTY**
2 YEAR Parts & Labor
5 YEAR Compressor**Intertek**

Certified to ANSI/NSF 7 Standards

**Intertek**



Model:

VP60G

61" Glass Door Back Bar Cooler

Two Section - Swing Door - 14 cu. ft. Capacity

Technical Data

Dimensional Data

Exterior Dimensions	61.1"W x 24.4"D x 42.3"H
Interior Dimensions	49.2"W x 21.6"D x 33.5"H
Net Storage Capacity	14 cu. ft.
Product Capacity	12oz btls 54 6-pks
Net Weight	287 lbs.
Crated Weight	357 lbs.
Shipping Dimensions	62.6"W x 26"D x 44.1"H

Refrigeration Data

Temperature Range	33°F - 41°F
Refrigerant	R290
Refrigerating System	Capillary Tube
Temperature Controller	Digital
Horsepower	2/5

Construction Data

Exterior Material	Black Powder Coat Steel
Interior Floor Material	Stainless Steel
Interior Wall Material	Stainless Steel
Insulation	2.4" CFC Free Polyurethane
Shelves	4 Heavy Duty Epoxy Coated

Electrical Data

Interior Lighting	Efficient LED
Amps	3
Voltage/Frequency/Phase	115V/60Hz/1
Plug Type	NEMA 5-15P
Electrical Cord Length	10 ft.

FRONT VIEW

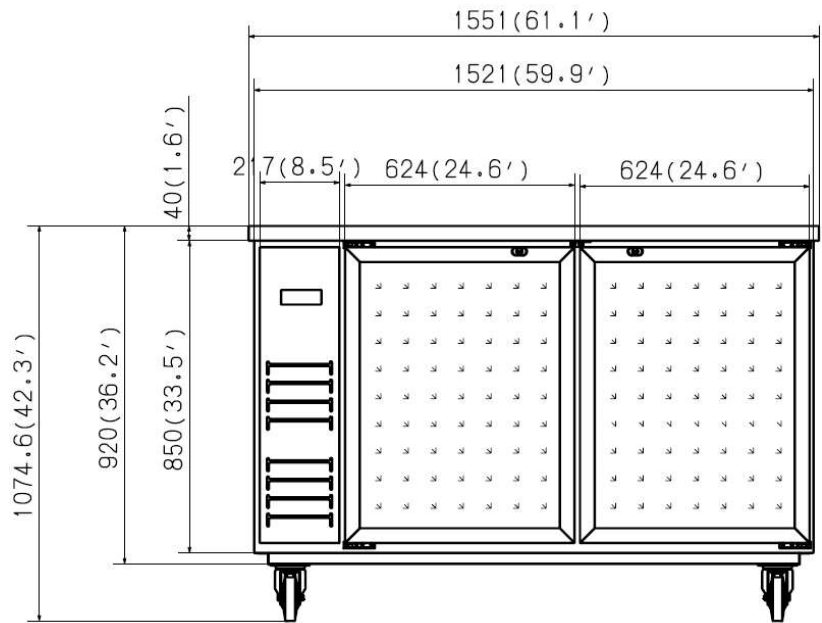

SIDE VIEW

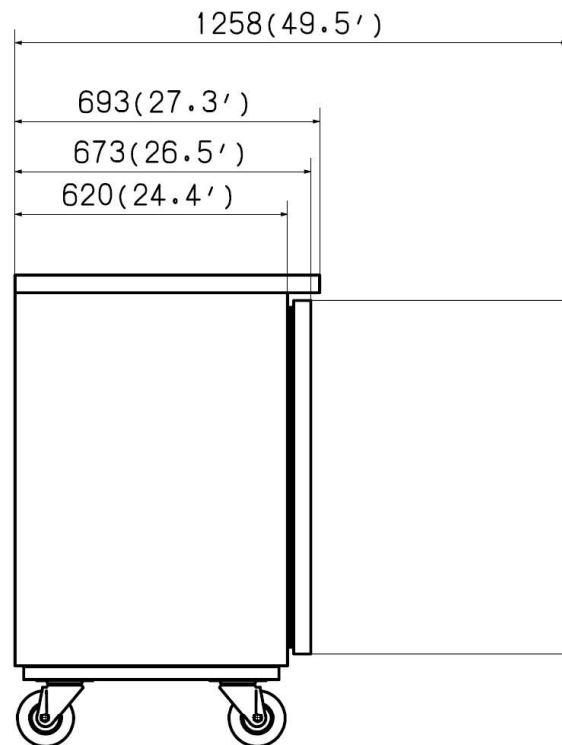

Valpro Commercial Refrigeration
5256 Eagle Trail Drive
Tampa, FL 33634



Tel: 813-502-0300
1-888-VALPRO-8
www.valprorefrigeration.com